

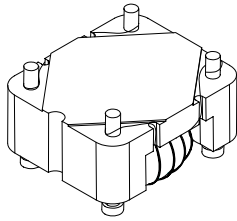

Common Mode Choke Transformer

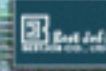

- ★ Improved EMI performance for FCC class B applications
- ★ Line to line isolation: 500 Vrms
- ★ Maximum common mode attenuation at 1MHz
- ★ Well suited for many Telecom applications

Specifications

Part Number	OCL (mH \pm 30%)	Common Mode Attenuation			Isolation Voltage (Vrms MIN)	DCR (Ω MAX)
		(dB TYP @100KHz)	(dB TYP @1MHz)	(dB TYP @10MHz)		
AC0002	4.7	40	51	38	500	1.0

Dimension

Schematic

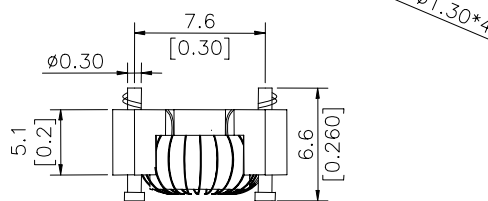
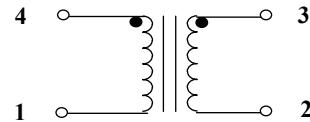
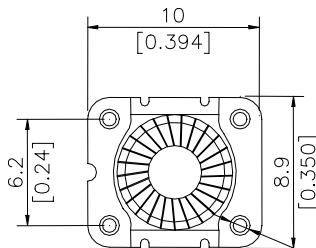
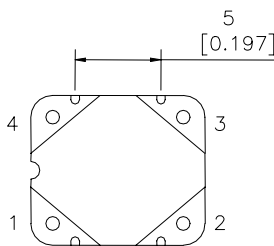

Data sheet subject to change without notice