

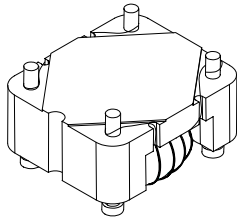

# Common Mode Choke Transformer



- ★ Improved EMI performance for FCC class B applications
- ★ Line to line isolation: 500 Vrms
- ★ Maximum common mode attenuation at 1MHz
- ★ Well suited for many Telecom applications

## Specifications

Part Number	OCL (mH $\pm$ 30%)	Common Mode Attenuation			Isolation Voltage (Vrms MIN)	DCR ( $\Omega$ MAX)
		(dB TYP @100KHz)	(dB TYP @1MHz)	(dB TYP @10MHz)		
AC0005	9.0	40	51	38	500	1.7

## Dimension

## Schematic

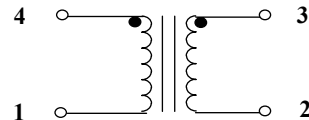
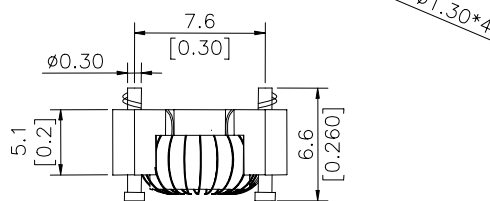
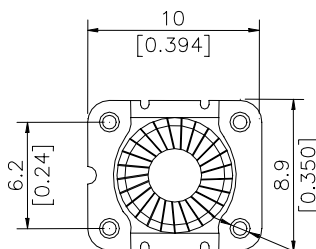
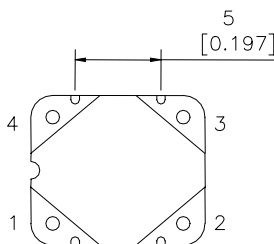

Data sheet subject to change without notice